

**CITY OF EDGERTON**  
**EDGERTON CITY HALL**  
**12 ALBION STREET**  
**EDGERTON, WI**

**PARKS & RECREATION COMMITTEE**  
Tuesday, November 7, 2023 at 6:00 pm

1. Call to order, Roll call.
2. Confirmation of appropriate meeting notice on Friday, November 3, 2023.
3. Approve October 10, 2023 Parks & Recreation Committee Meeting Minutes.
4. Consider grant application to Community Fund for corn hole equipment.
5. Consider play structure at Racetrack Park.
6. Consider striping basketball court at Dickinson Park for Four Square and Gagaball.
7. Consider sidewalk installation at Racetrack Park, Dickinson Park, and Orchard Park.
8. Consider dance floor area upgrades at Racetrack Park.
9. Aquatic Director's report.
10. Municipal Services Director's Report.
11. Adjourn.

cc: All Committee Members  
Newspaper

City Administrator  
All Council Members

Department Heads  
City Engineer

NOTICE: If a person with a disability requires that the meeting be accessible or that materials at the meeting be in an accessible format, call the City Administrator's office at least 6 hours prior to the meeting to request adequate accommodations. Telephone: 884-3341

"Notice is hereby given that a majority of the Common Council is expected to be present at the above scheduled noticed meeting to gather information about a subject over which they have decision-making responsibility. The only action to be taken at this meeting will be action by the Parks and Recreation Committee."

**OCTOBER 10, 2023 PARKS & RECREATION COMMITTEE MEETING MINUTES  
CITY OF EDGERTON**

Candy Davis called the meeting to order at 5:00 p.m.

Present: Candy Davis, Casey Langan, Denise Langan (left at 5:45pm), Jonathon Frey, and Kyle Furseth.

Excused: Samantha Higbee and Bonnie Slagg

Others Present: City Administrator Ramona Flanigan, Aquatics Director Anne Gohlke, Alderperson Jim Burdick, Mayor Christopher Lund, Municipal Services Director Howard Moser and citizens.

Flanigan confirmed the meeting notice was properly posted on Friday, October 6, 2023. Agendas were posted at Edgerton Post Office, Edgerton Public Library, City Hall and the City's website.

**APPROVAL OF MINUTES:** A Denise Langan/Casey Langan motion to approve the August 30, 2023 Parks & Recreation Committee meeting minutes passed, all voted in favor.

**2024 BUDGET:** Staff provided a list of Capital Projects for the draft 2024 budget, which included: trees for Fish Pond Park; netting at Racetrack Park; a skate park; toilet upgrades at Racetrack Park; plantings at the Pool and the Swift St pavilion; Racetrack Park playground equipment, and Pool playground equipment. The list also included a section of Pool Capital Equipment items such as a Funbrella, lounge chairs, and additional smaller objects/repairs.

The Committee went on to discuss other items/projects that were missing from the list that was presented. Jonathon Frey stated he would like to see bike route signs included in the budget. The Committee also discussed what developer/impact fees can and cannot be used for in regards to future park related items. Casey Langan mentioned that he would like to see a sign at the Racetrack Park walking trail entrance.

After additional discussion, the Committee prioritized the Capital Projects in the following order: toilet upgrades at Racetrack Park; trees for Fish Pond Park; plantings at the Pool and the Swift St pavilion; netting at Racetrack Park; a skate park; Racetrack Park playground equipment. The Committee decided to hold off another year on the Pool playground equipment.

Being no other business before the Committee, a Jonathon Frey/Casey Langan motion to adjourn passed, all voted in favor.

Ramona Flanigan/mjd  
City Administrator

# Memo

**To:** Parks Committee  
**From:** Staff  
**Date:** 11/1/2023  
**Re:** November 7, 2023 Meeting

---

**Corn hole grant application:** Grant applications are being accepted by the Edgerton Community Fund. Staff proposes to write an application to purchase two sets of corn hole (as known as sack toss or bags) games to be used in city parks. The idea is that the equipment will be moved to different parks throughout the summer and advertised on social media as to which park they are in. The goal is to get people out to see different parks to play the game. We will attach a GPS chip if possible so the equipment can be located using an app.

**Play structure at Racetrack Park:** The 2024 budget includes \$65,000 for the play structure at Racetrack Park. The attached drawings show some options for the structure.

Two options from Lee Recreation (Burke) cost \$88,386 and \$74,817 installed. For the GameTime option, the city's cost (assuming a 50% grant for the equipment) would be \$80,979.

Please study the options and provide input as to the structure preferred. The committee should also discuss if the budget shortfall should come from developer fees or if other park items should be removed from the budget. The uncommitted Developers fees balance is \$48,907. The following items are included in the 2024 budget (and are being funded with tax levy).

Netting RTP	\$5,000
Skate park	\$16,000
Toilet upgrades at RTP	\$3,000
Pool and Swift St pavilion planting	\$1,500
RTP playground equipment	\$56,471



Office (800) 775-8937  
 Fax (608) 423-7655

260 W. Main Street  
 Cambridge, WI 53523

info@leerecreation.com  
 www.leerecreation.com

PROVIDING FUN ACROSS WISCONSIN SINCE 1995

**DATE:** October 24, 2023  
**TO:** City of Edgerton  
 12 Albion St  
 Edgerton, WI 53534

**SOURCEWELL ID #:126324**

**PROJECT NAME:** Racetrack Park  
**PROJECT LOCATION:** Attn: Howard Moser  
 900 Stoughton Rd  
 Edgerton, WI 53534

**FROM:** Jeff Thompson  
**RE:** Playground Proposal #142-175759-1

**BURKE "Play That Moves You" - Sourcwell Contract #010521-BUR**

ITEM	DESCRIPTION	UNIT PRICE	TOTAL
142-175759-1	Nucleus 5-12 Structure	\$59,944.00	\$59,944.00
560-2579	Volta Inclusive Spinner	\$ 7,396.00	\$ 7,396.00
570-0053	4 Seat Rocker	\$ 3,306.00	\$ 3,306.00
580-0172	3-PVC Traditional Benches w/ Back	\$ 723.00	\$ 2,169.00
Discount	10% Discount Per Sourcwell Contract #010521-bur		(\$ 7,281.50)
Assembly	Assembly/Installation		\$21,850.00
Freight	Delivery of Equipment		<u>\$ 1,000.00</u>
<b>TOTAL</b>			<b>\$88,383.50</b>

Quote accepted by: \_\_\_\_\_ Date: \_\_\_\_\_

Benches not needed  
 -2169.00

Equipment & freight; Net 30 from completion date for all remaining  
 and Site Restoration is the responsibility of the Customer  
 out of order

RACETRACK PARK - EDGERTON

**Burke.**  
PLAY THAT MOVES YOU  
BCBURKE.COM • 800.266.1250

MADE WITH  
WISCONSIN  
CONCRETE

**LEE**  
RECREATION LLC

**COLOR KEY**

●	WWT
●	YELLOW
●	LIME
●	GRANITE
●	LUMBRICE
●	BLACK/GRAY



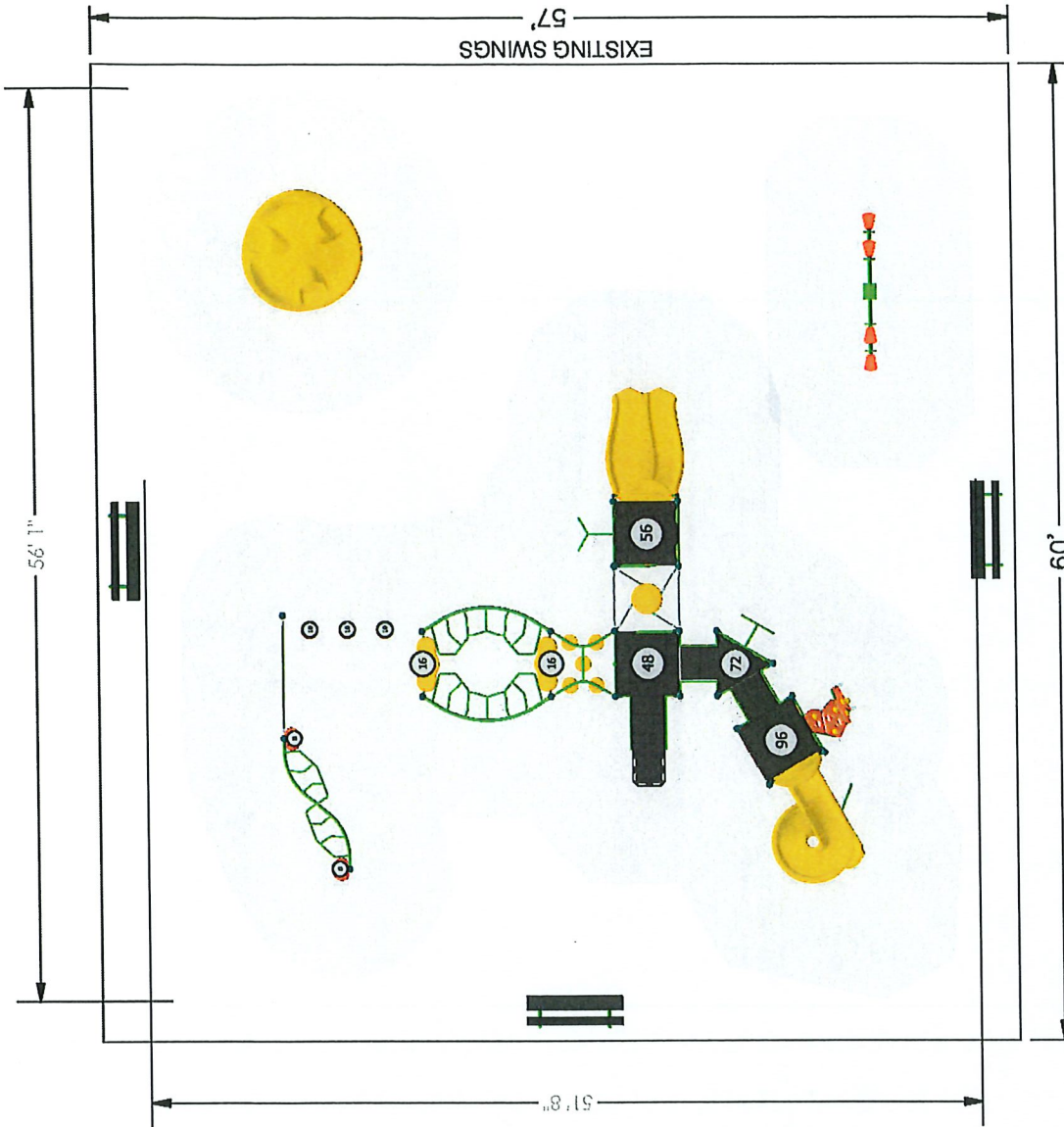

**NOTE: ALTHOUGH ALL ATTEMPTS HAVE BEEN MADE TO PROVIDE AN ACCURATE SITE IT MAY NOT TRULY REPRESENT THE AREA WHERE THIS STRUCTURE IS TO BE PLACED.**

**AREA: 3420 SQ. FT.**

The use and layout of play components identified in this plan conform to the CPSC guidelines. U.S. CPSC recommends the separation of age groups in playground layouts.

TOTAL EVENTS	PLAYGROUND ACCESSIBILITY (Provided/Required)			TYPES OF GROUND EVENTS
	ELEVATED EVENTS	TRANSFER ACCESSIBLE EVENTS	RAMP ACCESSIBLE EVENTS	
22	10 / 5	6 / 0	0 / 0	12 / 3
				7 / 3

**OVERALL BOUNDING OF USE ZONES**  
 Area: 2891.1 sq.ft.  
 Perimeter: 215.3 ft.  
 STRUCTURE SIZE: 51' 8" x 56' 1"  
 POST SIZE(S): 5"

\*\*The space requirements shown here are to ASTM standards. Requirements for other standards may be different.

**SERIES LINE: Nucleus | Intensity | Burke Basics**

**SITE PLAN VIEW**

**GROUP:**  
Structure | Freestanding

**Racetrack Park - Edgerton**

10/20/2023

Edgerton, WI 53534

**Lee Recreation, LLC**

**DESIGNED FOR AGES:**  
5 to 12

**Burke.**  
PLAY THAT MOVES YOU.

**142-175759-1**

Designer: Pa Der Vang

Warning: Accessible safety surfacing material is required beneath and around this equipment that is compliant with ASTM, CPSC, and ADAAG requirements.



Office (800) 775-8937  
 Fax (608) 423-7655

260 W. Main Street  
 Cambridge, WI 53523

info@leerecreation.com  
 www.leerecreation.com

PROVIDING FUN ACROSS WISCONSIN SINCE 1995

**DATE:** October 24, 2023  
**TO:** City of Edgerton  
 12 Albion St  
 Edgerton, WI 53534

**SOURCEWELL ID #:126324**

**PROJECT NAME:** Racetrack Park  
**PROJECT LOCATION:** Attn: Howard Moser  
 900 Stoughton Rd  
 Edgerton, WI 53534

**FROM:** Jeff Thompson  
**RE:** Playground Proposal #142-175757-1

**BURKE "Play That Moves You" - Sourcewell Contract #010521-BUR**

ITEM	DESCRIPTION	UNIT PRICE	TOTAL
142-175757-1	Nucleus 5-12 Structure	\$54,549.00	\$54,549.00
560-2586	Comet I	\$ 2,220.00	\$ 2,220.00
560-2584	Verve V Climber	\$ 4,694.00	\$ 4,694.00
Discount	10% Discount Per Sourcewell Contract #010521-bur		(\$ 6,146.30)
Assembly	Assembly/Installation		\$18,500.00
Freight	Delivery of Equipment		<u>\$ 1,000.00</u>
<b>TOTAL</b>			<b>\$74,816.70</b>

Quote accepted by: \_\_\_\_\_ Date: \_\_\_\_\_

- TERMS: Net 30 from ship date for equipment & freight; Net 30 from completion date for all remaining
- Site Preparation, Resilient Surfacing and Site Restoration is the responsibility of the Customer
- Lead-Time: 10-12 weeks upon receipt of order
- Quote effective: **Until 12-30-2023**

# RACETRACK PARK - EDGERTON

**Burke.**  
PLAY THAT MOVES YOU.  
BCBURKE.COM • 800.266.1250



**COLOR KEY**

●	NAVY
●	LIME
●	GRAY
●	YELLOW
●	GRANITE
●	LIME/PURPLE
●	GRAY/BLACK





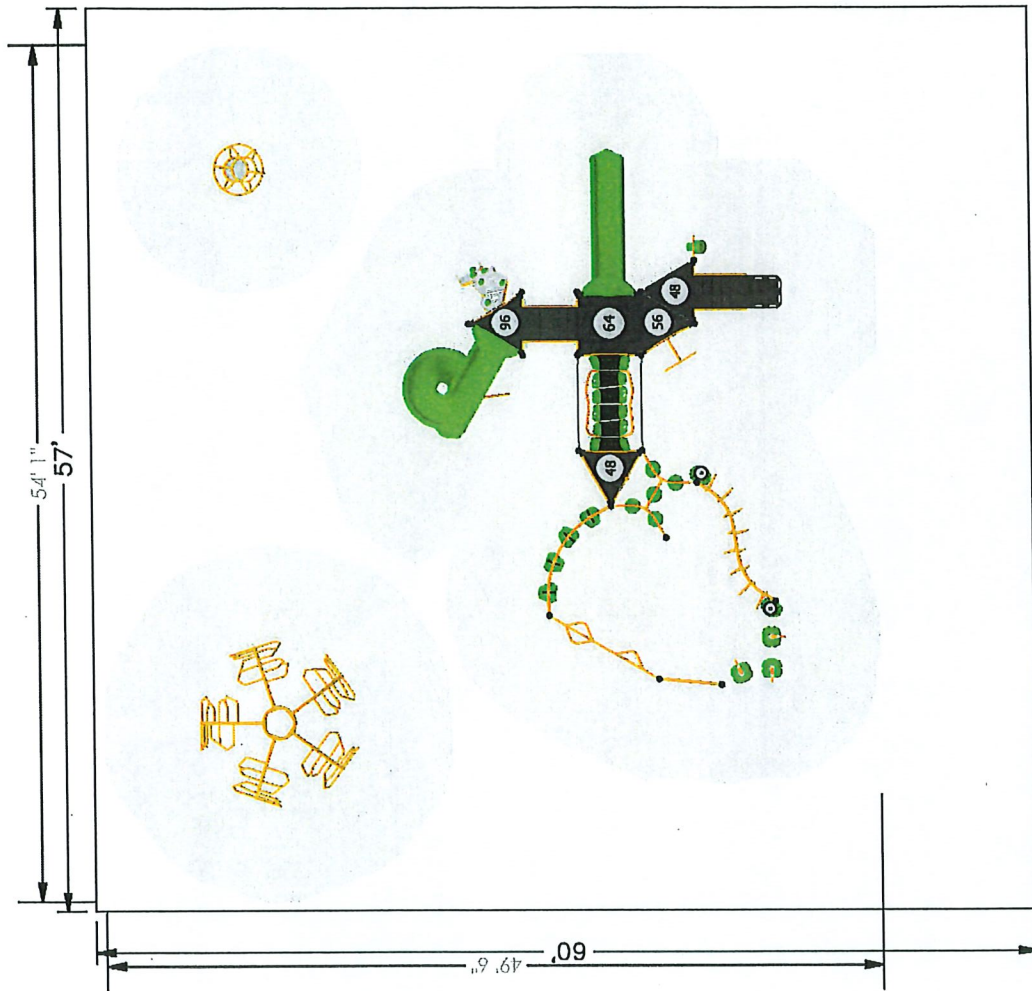

AREA: 3,420 SQ FT

NOTE: ALTHOUGH ALL ATTEMPTS HAVE BEEN MADE TO PROVIDE AN ACCURATE SITE IT MAY NOT TRULY REPRESENT THE AREA WHERE THIS STRUCTURE IS TO BE PLACED.

The use and layout of play components identified in this plan conform to the CPSC guidelines. U.S. CPSC recommends the separation of age groups in playground layouts.

PLAYGROUND ACCESSIBILITY (Provided/Required)			
TOTAL ELEVATED EVENTS	TRANSFER ACCESSIBLE EVENTS	RAMP ACCESSIBLE EVENTS	TYPES OF GROUND EVENTS
18	8 / 4	6 / 0	10 / 3 6 / 3

\*\*The space requirements shown here are to ASTM standards. Requirements for other standards may be different.

**OVERALL BOUNDING OF USE ZONES**  
 Area: 2675.6 sq. ft.  
 Perimeter: 207.1 ft.  
 STRUCTURE SIZE: 49' 6" x 54' 1"  
 POST SIZE(S): 5"

Warning: Accessible safety surfacing material is required beneath and around this equipment that is compliant with ASTM, CPSC, and ADAAG requirements.

**SERIES LINE:** Burke Basics | Nucleus | Intensity **SITE PLAN VIEW**

**GROUP:** Structure | Freestanding 10/19/2023

**DESIGNED FOR AGES:** 5 to 12 **Lee Recreation, LLC**

**Racetrack Park - Edgerton**  
Edgerton, WI 53534 **142-175757-1**

**Burke**  
PLAY THAT MOVES YOU. Designer: Kristin La Cross

BCI BURKE COMPANY, LLC | PO BOX 549 FOND DU LAC, WI 54936-0549 | 920.921.9220 | BCIBURKE.COM

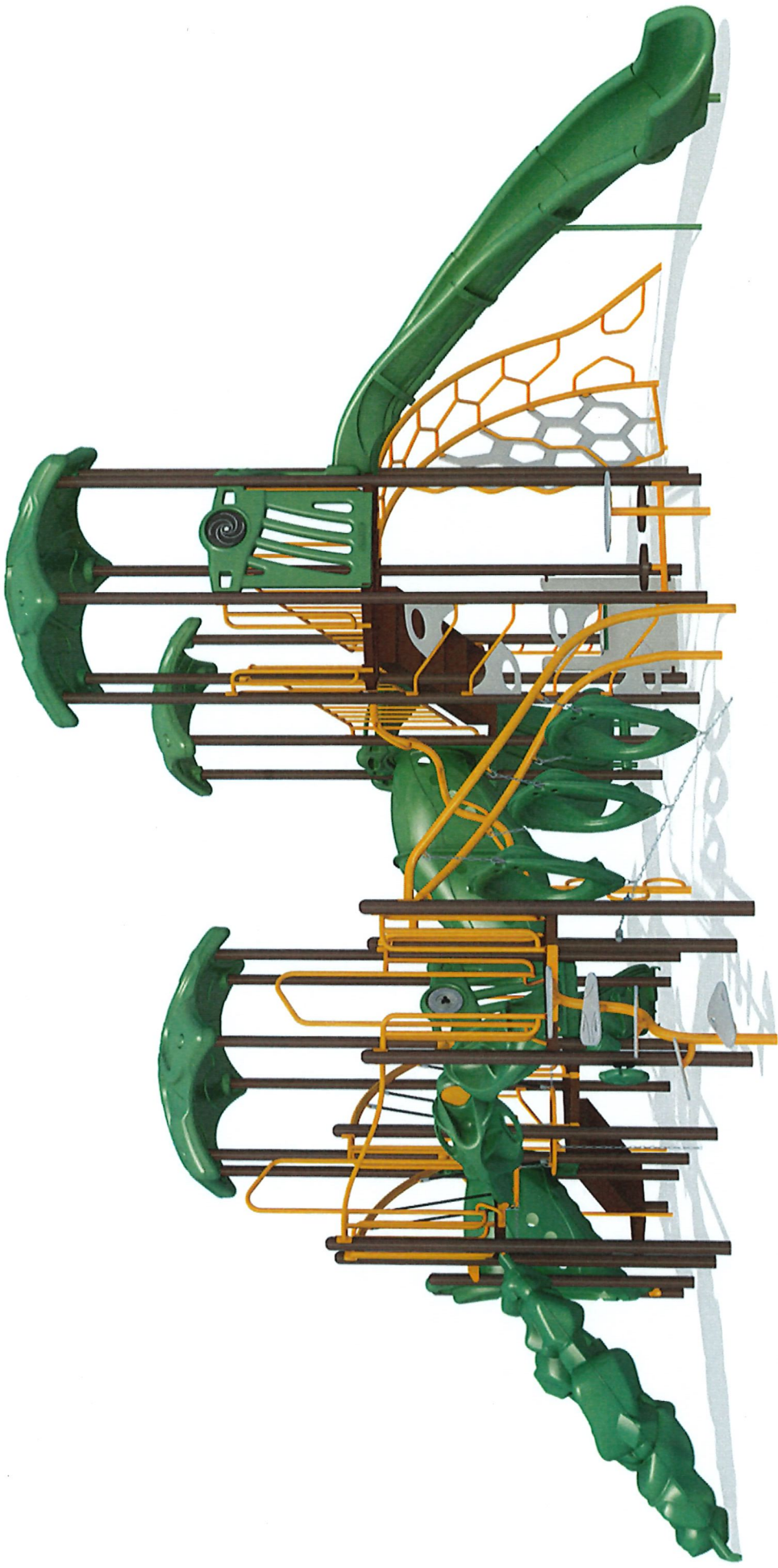

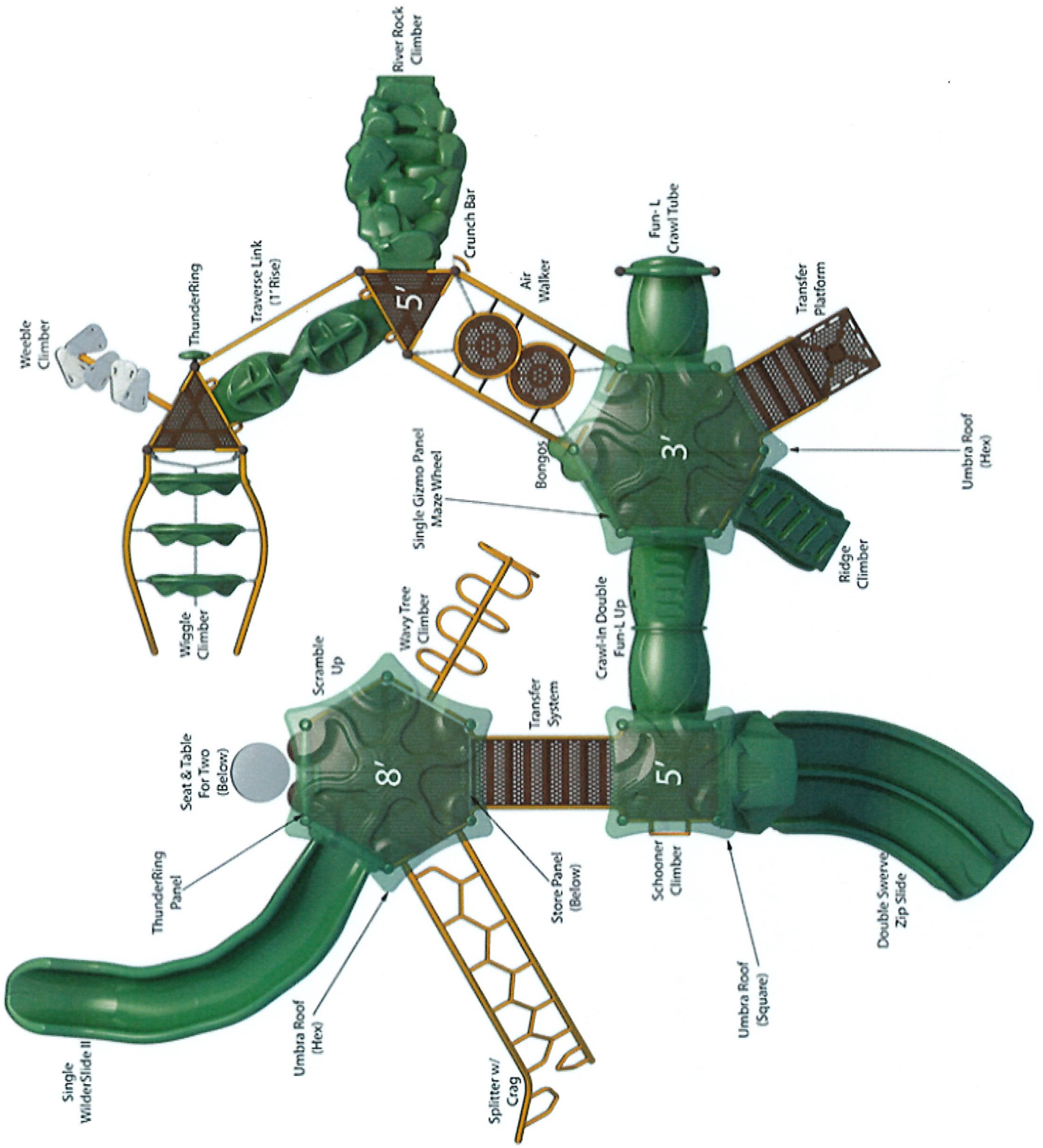

Weeble Climber

Single WilderSlide II

Thundering Panel

Seat & Table For Two (Below)

Umbr Roof (Hex)

Scramble Up

8'

Splitter w/ Crag

Store Panel (Below)

Umbr Roof (Square)

Schooner Climber

5'

Transfer System

Wavy Tree Climber

Single Gizmo Panel Maze Wheel

5'

Crunch Bar

River Rock Climber

Thundering Ring

Traverse Link (1" Rise)

Wiggle Climber

Air Walker

Bongos

Fun-L Crawl Tube

Transfer Platform

Ridge Climber

Umbr Roof (Hex)

Crawl-in Double Fun-L Up

Double Swerve Zip Slide